

PLAN VIEW

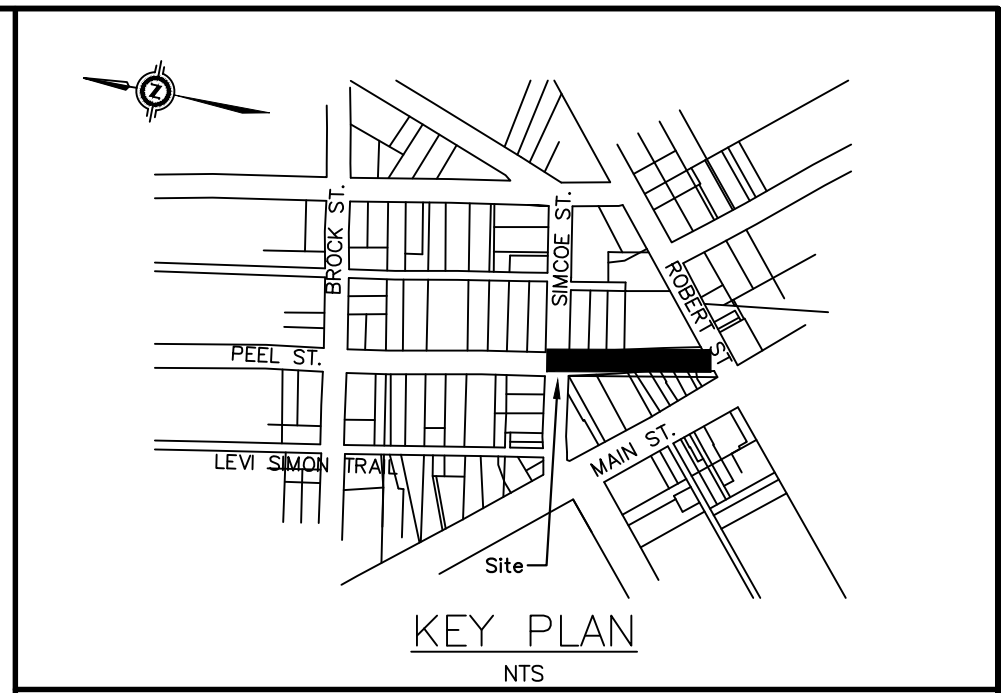

LEGEND

- EX STREET LIGHT
- EX UTILITY POLE
- EX FIRE HYD.
- EX EDGE OF PAVEMENT
- PR RETAINING WALL
- PROPERTY LINE

NOTE:

- DURING DETAILED DESIGN, LANDSCAPE/URBAN DESIGN TO CONSIDER OTHER STREETSCAPING, LANDSCAPING AND WASTE BIN SCREENINGS TO ENHANCE VIEW FROM ROBERT STREET EAST (IE. BOULEVARD LANDSCAPING/FENCING OR SIMILAR)
- DEPRESSED CURB AND/OR ROLLED CURBS TO BE PROVIDED FOR LOADING AREA, AS DETAILED GRADING DESIGN PERMITS.

NO.	BY	DATE	REVISION	REMARKS
1		AUG. 27/25	FOR DISCUSSION	
2		OCT. 1/25	REV'D PER TOWN COMMENTS	
3		OCT. 31/25	REV'D PER TOWN COMMENTS	
4		JAN. 09/26	REV'D PER TOWN COMMENTS	

BENCHMARK: ELEVATION = 203.332m
 OLD TORONTO-DOMINION BANK, AT CORNER OF MAIN AND ROBERT STREETS, TABLE IN NORTHWEST CONCRETE FOUNDATION, 30CM NORTHEAST OF NORTHWEST CORNER AND 30CM BELOW BRICKWORK.

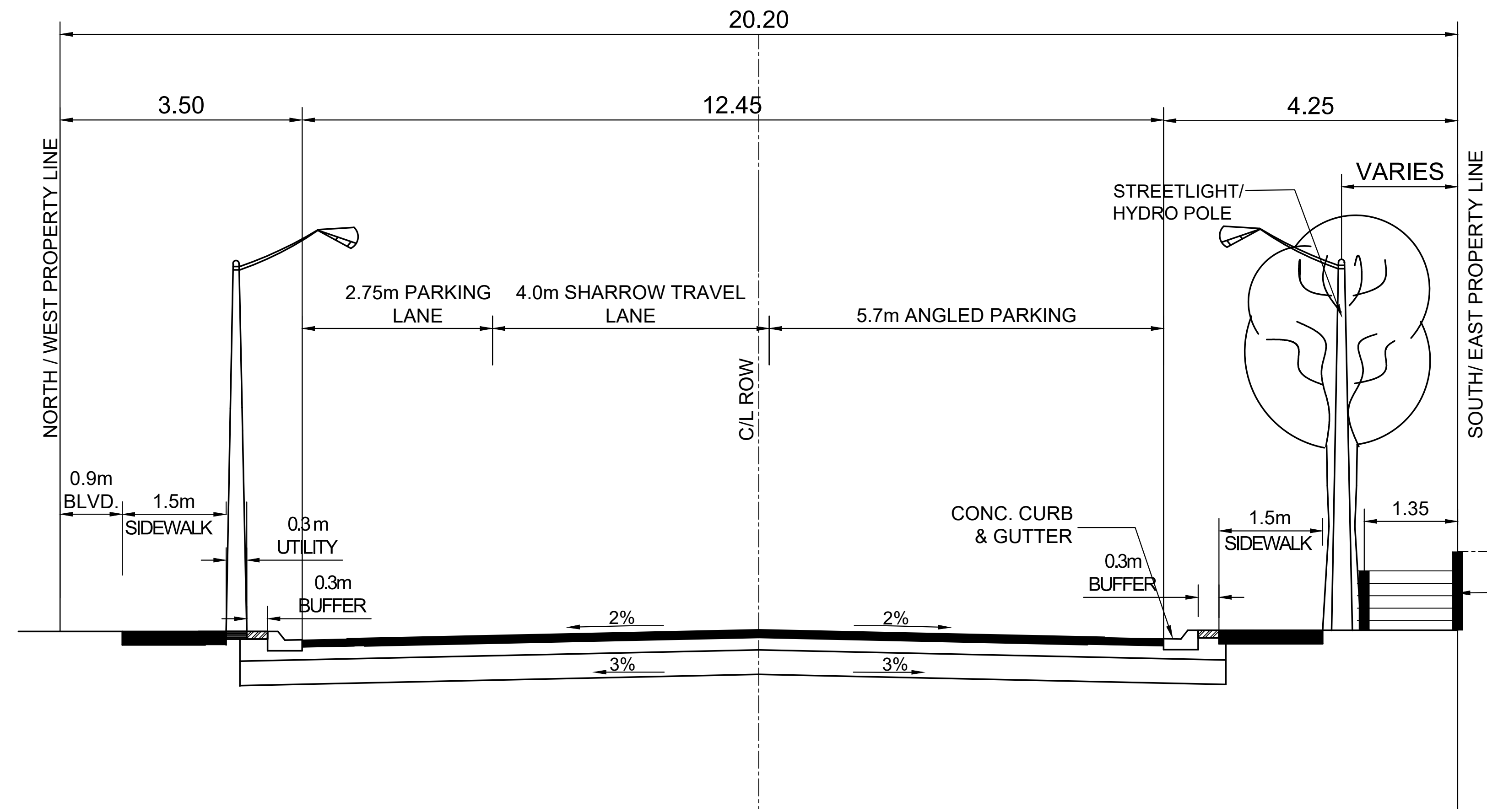

SECTION VIEW NTS

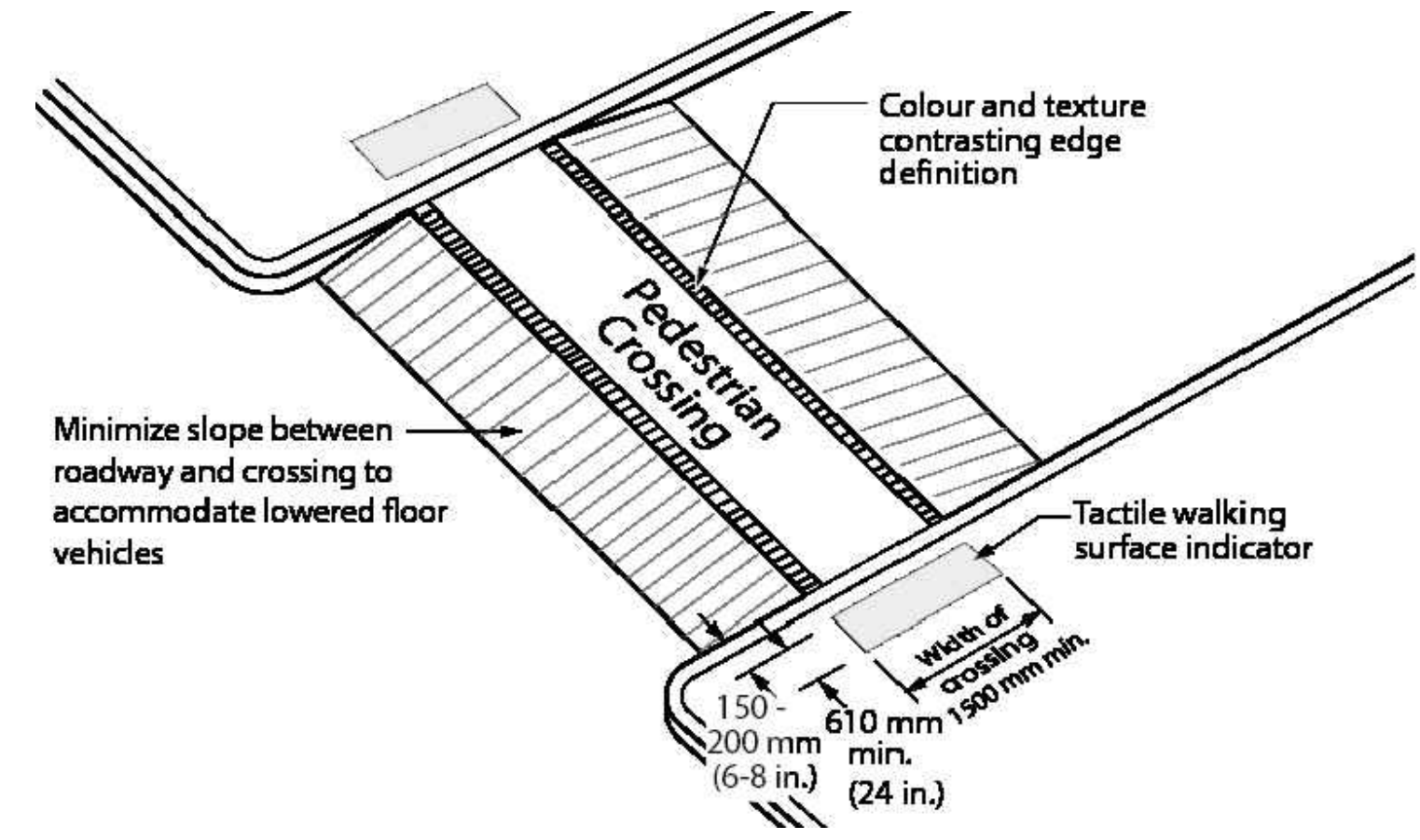

TYPICAL RAISED PEDESTRIAN CROSSING DETAIL

EX. GRADE

PROP. RETAINING WALL AND ACCESS STAIRS. FINAL LOCATION AND HEIGHTS TO BE VERIFIED DURING DETAILED DESIGN.

CONSULTANT:

GREENLAND Consulting Engineers
 120 Hume Street
 Collingwood, Ontario, L9Y 1V5
 Tel: (705) 444-9805
 Fax: (705) 444-5482
 E-mail: greenland@gnland.com
 Website: www.gnland.com

TOWN OF PENETANGUISHENE

PEEL ST. PRELIMINARY STREETSCAPE DESIGN

DRAWN BY: J.A.L.	CHECKED BY:	PROJECT No. 4039
DESIGNED BY: I.T.M.	CHECKED BY:	DRAWING No. OP2B
SCALE: 1:250	DATE: AUGUST 26, 2025	